



AC/DC POWER SUPPLY MODEL WE-107

Power Supplies For Instrumentation

The Model WE-107 is an instrumentation grade power supply designed specifically for panel mounting. Encapsulated circuitry with screw terminal wiring make this model the choice for on-board power applications and OEMs. The WE-107 features compact size, high current output, short circuit protection, and input isolation of 50 M Ω .

TECHNICAL SPECIFICATIONS

INPUT VOLTAGE:

105 to 125 Vac @ 50/420 Hz

OUTPUT:

24 VDC @ 400 mA

ISOLATION:

50 M Ω Input Isolation

ACCURACY:

Line regulation: \pm .1%

Load regulation: \pm .1%

OUTPUT RIPPLE:

1.0 mV rms (typical)

OPERATING TEMPERATURE RANGE:

-25°C to 71°C

ELECTRICAL CONNECTIONS:

5 Position Terminal Block



FEATURES

- 120 Hour Burn-In
- Short Circuit Protected

OPTIONS

- Snap Track
- Variety of outputs available. Contact the factory for specifics.

DWG. NO.
WSD-A-5008B

REVISIONS

B ECD # 176030196

SIDE VIEW

NOTE 1

TOP VIEW

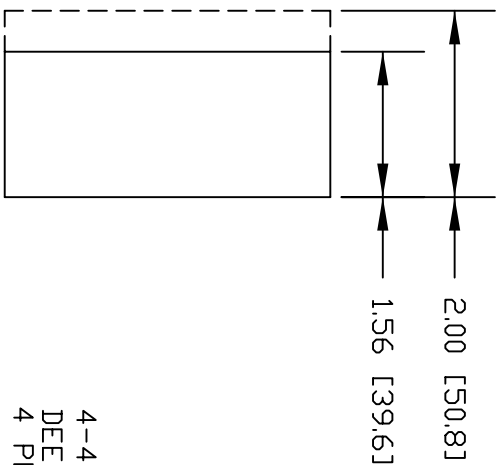
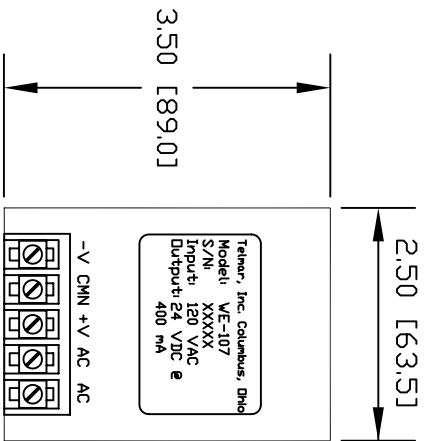

BOTTOM VIEW

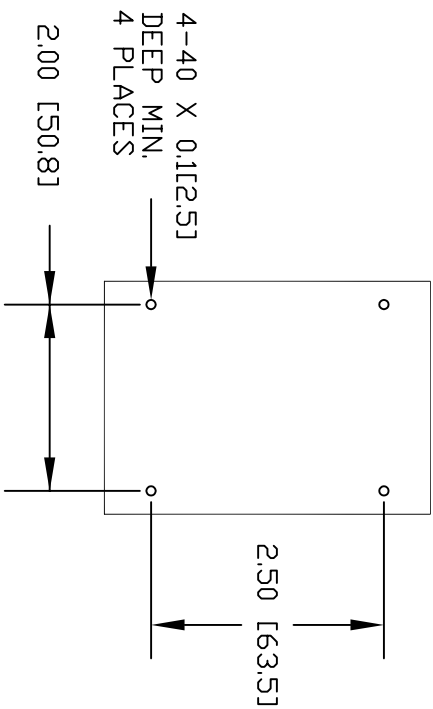

NOTES:

- 1.56 IS THE MAXIMUM DIMENSION FOR A 24 VDC, 400 mA POWER SUPPLY. CASE SIZE MAY CHANGE WITH DIFFERENT OUTPUTS NOT TO EXCEED 2.00.
- OTHER INPUTS AND OUTPUTS AVAILABLE, CONTACT FACTORY.
- DIMENSIONS IN BRACKETS ARE MILLIMETERS ALL OTHERS ARE INCHES.

QUOTE OR ORDER NUMBER

Dimensions in inches unless otherwise specified

DIMENSION TOLERANCES UNLESS OTHERWISE SPECIFIED

BASIC DIMENSIONS	FRACTIONAL	DECIMAL
UP TO 6	+/- 1/64	+/- .005
OVER 6 TO 24	+/- 1/32	+/- .005
OVER 24	+/- 1/16	+/- .010

SCALE 1/2 DO NOT SCALE DRAWING WORK TO DIMENSIONS

DRAWN RML DATE 4/1/96

CHECKED SC DATE 4/15/96

APPROVED JDR DATE 4/17/96

Telmar Inc.
COLUMBUS, OHIO

TITLE
DC POWER
FOR
MODEL WE-107

NEXT ASS'Y

DWG NO.
WSD-A-5008B

FILE NAME
EU000002.DWG