



# LOOP POWERED LCD INDICATOR MODEL 594000

The Model 594000 indicator measures user specified units as a function of loop current. The indicator is housed in a self-extinguishing plastic DIN enclosure and is panel mountable. An optional mounting bracket is available for flat surface mounting.

## LOOP POWERED LCD INDICATOR

### TECHNICAL SPECIFICATIONS

**INPUT RANGE:**

4 To 20 mA<sub>dc</sub>

**DISPLAY RANGE:**

-1999 To +1999

**ZERO:**

-1999 To +1999

**SPAN:**

± 2000 Counts Maximum

**ACCURACY:**

±0.1%, ± 1 digit

**POLARITY:**

Automatic Indication

**POWER:**

Loop Powered, 155 Ω Nominal

**OPERATING TEMPERATURE:**

0°F To 140°F

**DISPLAY:**

0.5" High, 3<sup>1</sup>/<sub>2</sub> Digit LCD

**DECIMAL POINT LOCATION:**

Programmable X.XXX, XX.XX, XXX.X, XXXX

**UPDATE TIME:**

3 Readings Per Second, Nominal



### FEATURES

- Loop Powered
- Field Selectable Ranging
- Large 1/2" Digits
- Selectable Decimal Point Positions
- Reverse Input Protection
- Field Selectable Reverse Acting Indication

### OPTIONAL

- Mounting Bracket: P/N C-53397A
- NEMA-4X-594001
- NEMA-7/9-Explosion Proof-594002

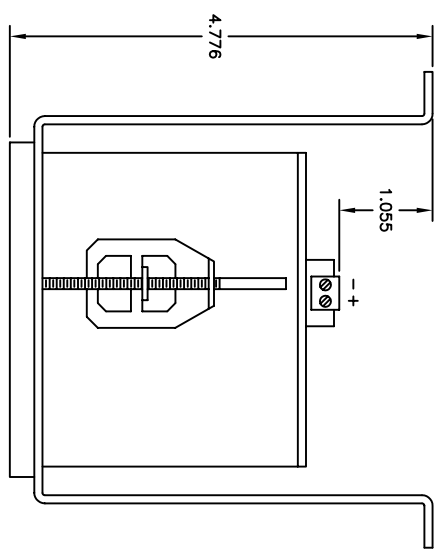

OPTIONAL MOUNTING BRACKET

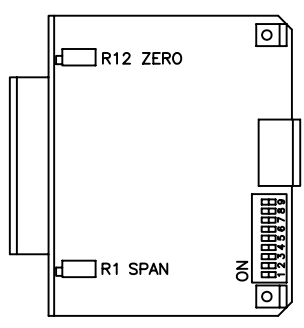

CALIBRATION ADJUSTMENTS

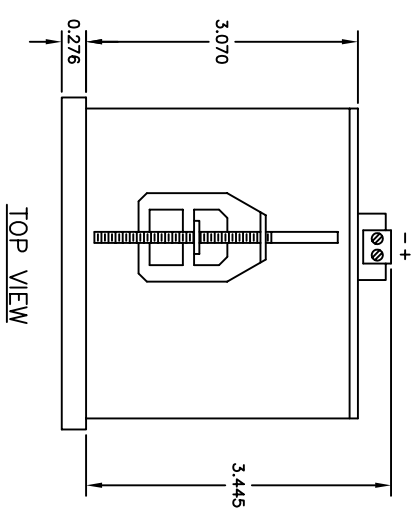

TOP VIEW

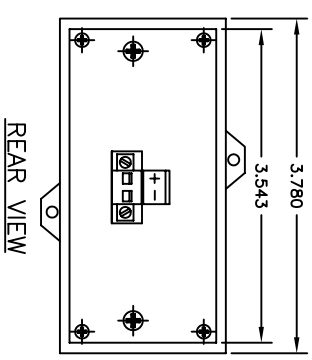

REAR VIEW

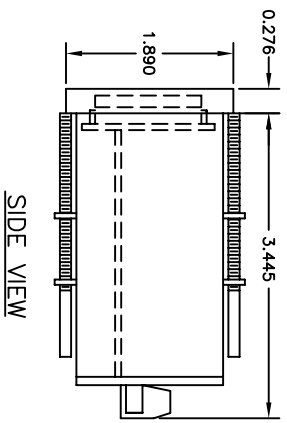

SIDE VIEW

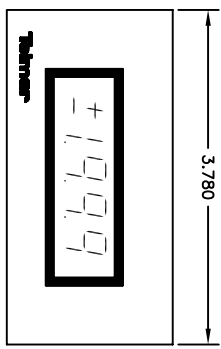

FRONT VIEW

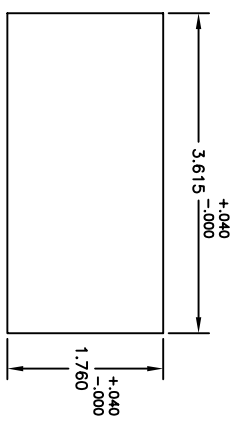

PANEL CUTOUIT

3. TO MOUNT, REMOVE RETAINING CLIPS FROM CASE AND INSERT METER THROUGH CUTOUIT. REPLACE CLIPS AND SNAP IN BEHIND THE MOUNTING PANEL. ADJUST SCREWS TO RETAIN METER.
2. FOR PANEL MOUNTING, EXISTING DIN/NEMA 92 M.M. x 45 M.M. AND 99.7 M.M. x 42.7 M.M. STD. CUTOUIITS CAN BE USED. RELIEF MAY BE REQUIRED IN CORNERS OF SOME EXISTING CUTOUIITS FOR PROPER FIT.
1. PANEL MOUNT:  
 ALLOW 4.00" BEHIND PANEL  
 PANEL THICKNESS .060" TO .180"

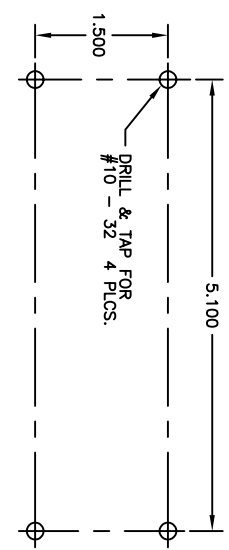

WALL MOUNT WITH OPTIONAL BRACKET

QUOTE OR ORDER NUMBER ANALYK WIRELESS, LLC 790 CROSS POINTE ROAD COLUMBUS, OHIO 43230	
DIMENSIONS IN INCHES UNLESS OTHERWISE SPECIFIED DIMENSIONS OVER 8 TO 24 OVER 24 SCALE 1X DRAWN DDD CHECKED JDR APPROVED SC DATE 02/20/95 DATE 09/02/96 DATE 09/02/96	TITLE DIGITAL INDICATOR FOR MODEL 594000 NEXT ASSY DWG. NO. SD-C-0166